

Produktgruppe HGST

Zylindrische Griffstange aus PA-GF mit Gewindestange

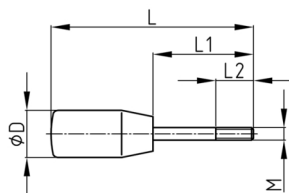

Standardfarben

- schwarz

Material

- Grundkörper: glasfaserverstärktes Polyamid (PA-GF)
- Gewinde: Stahl verzinkt

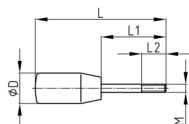

| Bestellnummer | D | L | L1 | L2 | M |
|----------------------|----|------|------|----|-----|
| | mm | mm | mm | mm | |
| HGST 18x70 / M6x9 | 18 | 79 | 34 | 9 | M6 |
| HGST 18x80 / M6x9 | 18 | 89 | 44 | 9 | M6 |
| HGST 18x95 / M6x9 | 18 | 104 | 59 | 9 | M6 |
| HGST 18x80 / M8x10 | 18 | 90 | 45 | 10 | M8 |
| HGST 18x95 / M8x10 | 18 | 105 | 60 | 10 | M8 |
| HGST 20x89,5 / M8x9 | 20 | 98,5 | 35,5 | 9 | M8 |
| HGST 20x98 / M8x10 | 20 | 108 | 45 | 10 | M8 |
| HGST 20x123 / M8x10 | 20 | 133 | 70 | 10 | M8 |
| HGST 20x153 / M8x11 | 20 | 164 | 101 | 11 | M8 |
| HGST 20x200 / M8x11 | 20 | 211 | 148 | 11 | M8 |
| HGST 24x125 / M10x15 | 24 | 140 | 64 | 15 | M10 |
| HGST 24x140 / M10x15 | 24 | 155 | 79 | 15 | M10 |
| HGST 24x160 / M10x15 | 24 | 175 | 99 | 15 | M10 |
| HGST 24x200 / M10x15 | 24 | 215 | 139 | 15 | M10 |
| HGST 24x141 / M12x12 | 24 | 153 | 77 | 12 | M12 |
| HGST 28x130 / M12x15 | 28 | 145 | 58 | 15 | M12 |
| HGST 28x145 / M12x15 | 28 | 160 | 72 | 15 | M12 |
| HGST 28x200 / M12x15 | 28 | 215 | 128 | 15 | M12 |
| HGST 28x105 / M14x16 | 28 | 121 | 34 | 16 | M14 |
| HGST 28x130 / M14x16 | 28 | 146 | 59 | 16 | M14 |
| HGST 28x145 / M14x16 | 28 | 161 | 74 | 16 | M14 |
| HGST 28x200 / M14x16 | 28 | 216 | 129 | 16 | M14 |