

Produktgruppe KBKZ25

Universalkupplung aus PP zur richtungsunabhängigen Verbindung fast aller KBK Systembauteilen, wenn diese "mit dem Rücken" zueinander stehen.

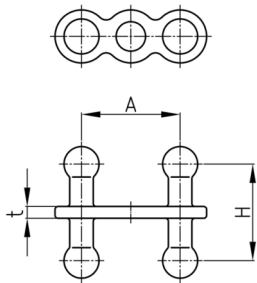

Standardfarben

- schwarz
- weiß
- natur - transluzent
- silber

Material

- Polypropylen (PP)

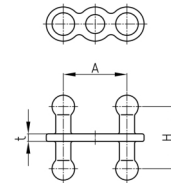
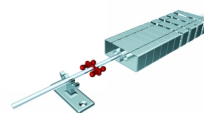
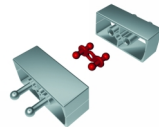
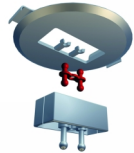
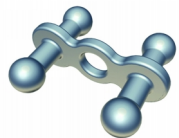

Bestellnummer	A	L	t
	mm	mm	mm
KBKZ25 Connect	17	16	2