

Product Group MFCSB

Articulated machine feet made of glass fibre reinforced polyamide with stainless steel thread and antislip pad (A)

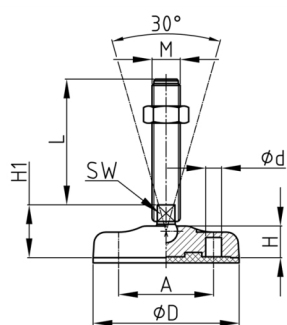

Standard Colours

- black

Material

- Thread: AISI 304 (A2)
- Base: glass fibre reinforced polyamide (PA-GF)
- Antislip pad: NBR 70 Shore

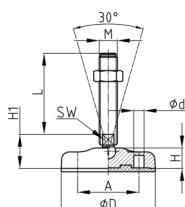

Product information

- There are two prepared screw-on holes (closed).
- The machine foot can compensate for uneven floors up to 30°.
- The load capacity of the screw (buckling length!) may be less than indicated in the table.
- Packaging industry, conveyor systems, automation industry, office desks, aluminium profiles

Product options on inquiry

- Delivery with additional steel nut possible.
- Thread made of stainless steel AISI 316 (A4)

| A | D | d | F max. | H | H1 | M | WAF | 50 | 100 | 150 | 200 | 250 |
|----|-----|------|--------|----|----|-----|-----|----|-----|-----|-----|-----|
| mm | mm | mm | kg | mm | mm | | mm | mm | mm | mm | mm | mm |
| 54 | 83 | 8,5 | 1000 | 18 | 30 | M10 | 7 | x | x | x | | |
| 54 | 83 | 8,5 | 1300 | 18 | 30 | M12 | 9 | x | x | x | | |
| 54 | 83 | 8,5 | 1600 | 18 | 30 | M16 | 13 | | x | x | x | |
| 54 | 83 | 8,5 | 1800 | 18 | 32 | M20 | 17 | | x | x | x | x |
| 73 | 103 | 12,5 | 1800 | 20 | 32 | M16 | 13 | | x | x | x | |
| 73 | 103 | 12,5 | 2000 | 20 | 32 | M20 | 17 | | x | x | x | x |
| 73 | 103 | 12,5 | 2500 | 20 | 32 | M24 | 20 | | x | x | x | x |
| 87 | 123 | 12,5 | 1800 | 22 | 34 | M16 | 13 | | x | x | x | |
| 87 | 123 | 12,5 | 2000 | 22 | 36 | M20 | 17 | | x | x | x | x |
| 87 | 123 | 12,5 | 2500 | 22 | 36 | M24 | 20 | | x | x | x | x |
| 87 | 123 | 12,5 | 2500 | 22 | 36 | M30 | 20 | | x | | | |
| 87 | 123 | 12,5 | 2500 | 22 | 36 | M30 | 26 | | | x | x | x |

Ordering example

- Group + D + M + Thread Length ----> MFCSB 83 M16x 100 (A)