

Product Group MFCW

Articulated machine feet made of glass fibre reinforced polyamide with galvanized steel thread, foot/thread cover and antislip pad (A)

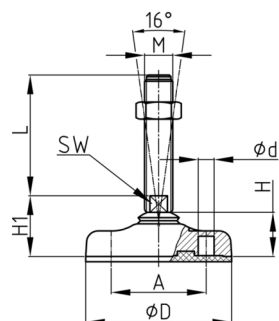

Standard Colours

- black

Material

- Thread: zinc-plated steel
- Base: glass fibre reinforced polyamide (PA-GF)
- Antislip pad: NBR 70 Shore

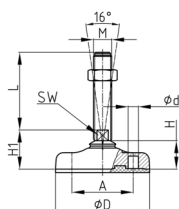

Product information

- There are two prepared screw-on holes (closed).
- The machine foot can compensate for slopes of up to 16° on floors and equipment.
- The load capacity of the screw (buckling length!) may be less than indicated in the table.
- Packaging industry, conveyor systems, automation industry, office desks, aluminium profiles
- Food industry

Product options on inquiry

- Delivery with additional steel nut possible.

A	D	d	F max.	H	H1	M	WAF	50	100	150	200	250
mm	mm	mm	kg	mm	mm		mm	mm	mm	mm	mm	mm
54	83	8,5	1400	25	35	M12	9	x	x	x		
54	83	8,5	2000	25	35	M16	13		x	x	x	
54	83	8,5	2000	25	37	M20	17		x	x	x	x
54	83	8,5	2000	25	37	M24	20		x	x	x	x
73	103	12,5	3000	26	36	M16	13		x	x	x	
73	103	12,5	3000	26	36	M20	17		x	x	x	x
73	103	12,5	3000	26	36	M24	20		x	x	x	x
87	123	12,5	3500	29	39	M16	13		x	x	x	
87	123	12,5	3500	29	41	M20	17		x	x	x	x
87	123	12,5	3500	29	41	M24	20		x	x	x	x
87	123	12,5	3500	29	41	M30	26		x	x	x	x

Ordering example

- Group + D + M + Thread Length ----> MFCW 83 M16x 100 (A)