

Product Group GLAF

Lamella plugs made of PE for round tubes with welded felt

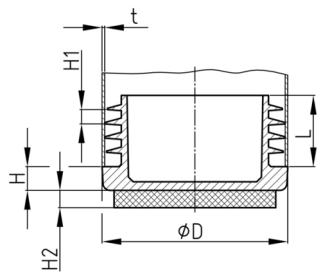

Standard Colours

- black RAL 9005

Material

- Base body: Polyethylene (PE)
- Slide base: synthetic needle felt (polyester)

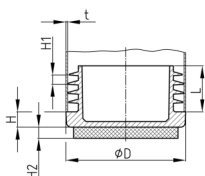

Product information

- Lamellar plugs without specification of the pipe wall thickness are generally suitable for pipe wall thicknesses 1.5 - 2 mm. Please indicate the pipe wall thickness when ordering.
- The plugs are intended for use in pipes or equivalent bores with free passage corresponding to the clear nominal width of at least shaft length.
- For technical production reasons, a residual sprue may exceed the shaft length.
- Material and design of shafts guaranteed stop against drop out and easy assembling.
- The ribs are circularly closed or interrupted.
- The ribs are not suitable for sealing against fluids.

Product options on inquiry

- Special colours (colours, minimum quantities, set-up costs, pricing and surcharges)

Order Number	D	H	H1	H2	L	t
	mm	mm	mm	mm	mm	mm
GLAF 12	12	3,5	2,5	3,5	10	0,8-2
GLAF 13	13	4	3	3,5	11,5	0,8-2
GLAF 14	14	5	3	3,5	10,5	0,8-2
GLAF 15	15	3	3	3,5	11,5	0,8-2
GLAF 16	16	5	3	3,5	11,5	0,8-2
GLAF 18	18	5	3	3,5	11,5	0,8-2,5
GLAF 19	19	5	3	3,5	11,5	0,8-2,5
GLAF 20	20	5	3	3,5	11,5	0,8-2,5
GLAF 22	22	5	3	3,5	11,5	0,8-3
GLAF 23	23	5	3	3,5	11,5	0,8-3
GLAF 25	25	5	3	3,5	11,5	1-3
GLAF 26	26	5	3	3,5	11,5	0,8-3
GLAF 28	28	5	3	3,5	11,5	0,8-2,5
GLAF 30	30	5	3	3,5	11,5	0,8-2,5
GLAF 32	32	5	3	3,5	11,5	0,8-3
GLAF 35	35	5	3	3,5	11,5	1-3
GLAF 40	40	5	3	3,5	11,5	1-3
GLAF 42	42	5	3	3,5	11,5	0,8-2,5



Walter Bethke GmbH & Co. KG

Technische Kunststoff - und Hybridprodukte