

### Product Group VJK/R

Adjusting plugs made of PA 6 for rectangular tubes with two-piece outer body and injection-moulded thread

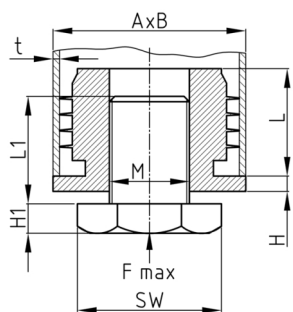

#### Standard Colours

- black

#### Material

- Polyamide 6 (PA 6)

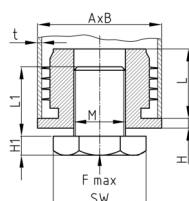

• The specified axial, static load capacity refers to a screw turned out 10 mm and resting on the full surface. • Adjusting plugs are not suitable as load gliders. • Adjusting plugs are not suitable for dynamic load. • The feet must be adjusted in an unloaded state.

- \* ) = Order related production! Please ask for minimum quantity.
- ... / 8 = screw head is 8 mm high
- ... / 21 = screw head = WAF 21
- Your searched size / design is not included? - Please ask our sales team!
- Please observe the material hints for polyamide (PA).

#### Product options on inquiry

- Further sizes
- Other special productions

Order Number	A	B	F max.	H	H1	L	L1	M	WAF	t
	mm	mm	kg	mm	mm	mm	mm		mm	mm
VJK30x20 / M12x30	30	20	100	5	5	23-34	32	M12	19	1,5-2
VJK30x20 / M12x50	30	20	100	5	5	23-34	52	M12	19	1,5-2
VJK40x20 / M12x30	40	20	100	5	5	23-34	32	M12	19	1,5-2
VJK40x20 / M12x50	40	20	100	5	5	23-34	52	M12	19	1,5-2
VJK40x25x2 / M16x30/21 *	40	25	150	5	8	23-34	40	M16	21	2
VJK40x25x2 / M16x30 *	40	25	150	5	5	23-34	37	M16	27	2
VJK40x25x2 / M16x30/8 *	40	25	150	5	8	23-34	39	M16	27	2
VJK40x25x3 / M12x30 *	40	25	100	5	5	23-34	32	M12	19	3
VJK40x25x3 / M12x50 *	40	25	100	5	5	23-34	52	M12	19	3
VJK40x27 / M22x30 *	40	27	250	5	5	23-34	35	M22	27	1,5
VJK40x27 / M22x30/8 *	40	27	250	5	8	23-34	38	M22	27	1,5
VJK40x27 / M22x50 *	40	27	250	5	5	23-34	52	M22	27	1,5
VJK40x27 / M22x80 *	40	27	250	5	5	23-34	85	M22	27	1,5
VJK40x30 / M22x30	40	30	250	5	5	23-34	35	M22	27	1,5-2
VJK40x30 / M22x30/8	40	30	250	5	8	23-34	38	M22	27	1,5-2
VJK40x30 / M22x50	40	30	250	5	5	23-34	52	M22	27	1,5-2
VJK40x30 / M22x80	40	30	250	5	5	23-34	85	M22	27	1,5-2



# Walter Bethke GmbH & Co. KG

Technische Kunststoff - und Hybridprodukte

Order Number	A	B	F max.	H	H1	L	L1	M	WAF	t
	mm	mm	kg	mm	mm	mm	mm		mm	mm
VJK40x30x3 / M22x30 *	40	30	250	5	5	23-34	35	M22	27	2,5-3
VJK40x30x3 / M22x30/8 *	40	30	250	5	8	23-34	38	M22	27	2,5-3
VJK40x30x3 / M22x50 *	40	30	250	5	5	23-34	52	M22	27	2,5-3
VJK40x30x3 / M22x80 *	40	30	250	5	5	23-34	85	M22	27	2,5-3
VJK45x25 / M16x30/21 *	45	25	150	5	8	23-34	40	M16	21	1,5-2
VJK45x25 / M16x30 *	45	25	150	5	5	23-34	37	M16	27	1,5-2
VJK45x25 / M16x30/8 *	45	25	150	5	8	23-34	39	M16	27	1,5-2
VJK50x20 / M12x30	50	20	100	5	5	23-34	32	M12	19	1,5-2
VJK50x20 / M12x50	50	20	100	5	5	23-34	52	M12	19	1,5-2
VJK50x25 / M16x30/21 *	50	25	150	5	8	23-34	40	M16	21	1,5-2
VJK50x25 / M16x30 *	50	25	150	5	5	23-34	37	M16	27	1,5-2
VJK50x25 / M16x30/8 *	50	25	150	5	8	23-34	39	M16	27	1,5-2
VJK50x30 / M22x30	50	30	250	5	5	23-34	35	M22	27	1,5-2
VJK50x30 / M22x30/8	50	30	250	5	8	23-34	38	M22	27	1,5-2
VJK50x30 / M22x50	50	30	250	5	5	23-34	52	M22	27	1,5-2
VJK50x30 / M22x80	50	30	250	5	5	23-34	85	M22	27	1,5-2
VJK50x40 / M22x30	50	40	250	5	5	23-34	35	M22	27	1,5-2
VJK50x40 / M22x30/8	50	40	250	5	8	23-34	38	M22	27	1,5-2
VJK50x40 / M22x50	50	40	250	5	5	23-34	52	M22	27	1,5-2
VJK50x40 / M22x80	50	40	250	5	5	23-34	85	M22	27	1,5-2
VJK55x25 / M16x30/21	55	25	150	5	8	23-34	40	M16	21	1,5-2
VJK55x25 / M16x30	55	25	150	5	5	23-34	37	M16	27	1,5-2
VJK55x25 / M16x30/8	55	25	150	5	8	23-34	38	M16	27	1,5-2
VJK55x34 / M22x30	55	34	250	5	5	23-34	35	M22	27	1,5-2
VJK55x34 / M22x30/8	55	34	250	5	8	23-34	38	M22	27	1,5-2
VJK55x34 / M22x50	55	34	250	5	5	23-34	52	M22	27	1,5-2
VJK55x34 / M22x80	55	34	250	5	5	23-34	85	M22	27	1,5-2
VJK60x30 / M22x30	60	30	250	5	5	23-34	35	M22	27	1,5-2
VJK60x30 / M22x30/8	60	30	250	5	8	23-34	38	M22	27	1,5-2
VJK60x30 / M22x50	60	30	250	5	5	23-34	52	M22	27	1,5-2
VJK60x30 / M22x80	60	30	250	5	5	23-34	85	M22	27	1,5-2
VJK60x30x3 / M16x30/21 *	60	30	150	5	8	23-34	40	M16	21	3
VJK60x30x3 / M16x30 *	60	30	150	5	5	23-34	37	M16	27	3
VJK60x30x3 / M16x30/8 *	60	30	150	5	8	23-34	38	M16	27	3
VJK60x40 / M22x30	60	40	250	5	5	23-34	35	M22	27	1,5-2
VJK60x40 / M22x30/8	60	40	250	5	8	23-34	38	M22	27	1,5-2
VJK60x40 / M22x50	60	40	250	5	5	23-34	52	M22	27	1,5-2
VJK60x40 / M22x80	60	40	250	5	5	23-34	85	M22	27	1,5-2
VJK80x30 / M22x30	80	30	250	5	5	23-34	35	M22	27	1,5-2
VJK80x30 / M22x30 / 8	80	30	250	5	8	23-34	38	M22	27	1,5-2
VJK80x30 / M22x50	80	30	250	5	5	23-34	52	M22	27	1,5-2
VJK80x30 / M22x80	80	30	250	5	5	23-34	85	M22	27	1,5-2
VJK 100x40 / M22x30 *	100	40	250	5	5	23-34	35	M22	27	1,5-2
VJK100x40 / M22x30/8 *	100	40	250	5	8	23-34	38	M22	27	1,5-2
VJK 100x40x2,5-3 / M22x30 *	100	40	250	5	8	23-34	38	M22	27	2,5-3
VJK100x40 / M22x50 *	100	40	250	5	5	23-34	52	M22	27	1,5-2
VJK100x40 / M22x80 *	100	40	250	5	5	23-34	85	M22	27	1,5-2



# Walter Bethke GmbH & Co. KG

Technische Kunststoff - und Hybridprodukte