

### Product Group KRG2B

Cross handles made of PP with overmoulded threaded bush

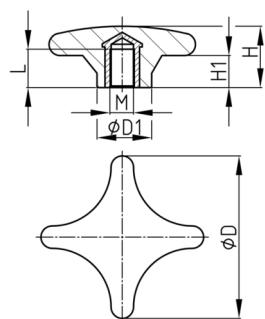

#### Standard Colours

- black

#### Material

- Base body: Polypropylene (PP)
- Thread: zinc-plated steel

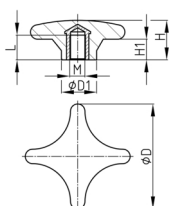

Order Number	D	D1	H	H1	L	M
	mm	mm	mm	mm	mm	
KRG2B 48 M5x12	48	17	19	6,5	12	M5
KRG2B 48 M6x12	48	17	19	6,5	12	M6
KRG2B 48 M8x12	48	17	19	6,5	12	M8