

Product Group HKRL

Crank handle made of PA 6 with long stud

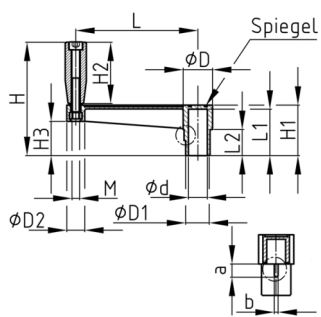

Standard Colours

- black

Material

- Base body: Polyamide (PA 6)
- Thread bolt: zinc-plated steel
- Handle: thermosetting PF 31

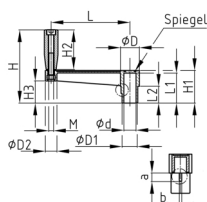

| Order Number | D | D1 | D2 | d | H | H1 | H2 | H3 | L | L1 | L2 | M | a | b |
|---------------|----|----|----|----|-----|----|----|----|-----|----|----|-----|----|----|
| | mm | mm | mm | mm | mm | mm | mm | mm | mm | mm | mm | | mm | mm |
| HKRL 150 / 29 | 36 | 29 | 22 | 18 | 160 | 70 | 80 | 49 | 150 | 62 | 39 | M10 | 15 | 10 |