

Product Group BGEB

U-handle made of PA with covers and threaded bush, elliptical shaped

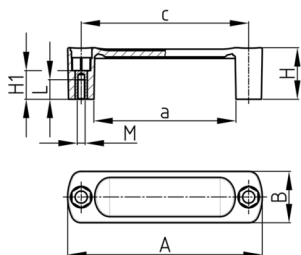

Standard Colours

- black

Material

- Base body: Polyamide (PA)
- Top cover: Polypropylene (PP)
- Thread: Brass

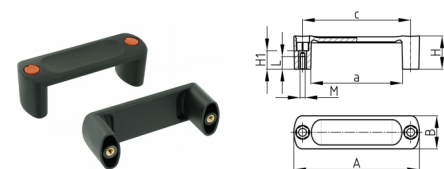

Order Number	A	a	B	c	H	H1	L	M
	mm	mm	mm	mm	mm	mm	mm	mm
BGEB 93,5 / M5	114	76	36	93,5	36	20	14	M5
BGEB 93,5 / M6	114	76	36	93,5	36	20	18	M6
BGEB 117 / M6	137	99	36	117	36	20	18	M6
BGEB 117 / M8	137	99	36	117	36	20	18	M8