

Product Group 88 ISK

Adjusting screws with octagonal plastic base made of PA and hexagon inside the thread end, thread bolt overmoulded

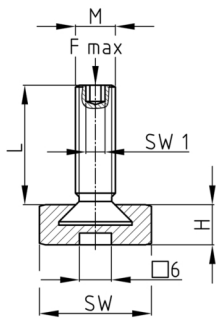

Standard Colours

- black

Material

- Base: Polyamide (PA)
- Thread: zinc-plated steel

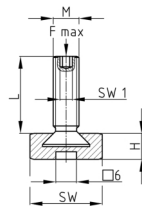

- The axial, static load capacity with a complete flat resting screw is 500 kg.
- 6 mm square in base underside

Product options on inquiry

- Additional sizes
- Stainless steel screws
- Plastic base in special colours according to RAL-System

Order Number	F max. kg	H mm	L mm	M	WAF mm	SW1 mm
88-27/9 M10x25 ISK	400	9	21	M10	27	4
88-27/9 M10x30 ISK	400	9	26	M10	27	4
88-27/9 M10x40 ISK	400	9	36	M10	27	4
88-27/9 M10x50 ISK	400	9	46	M10	27	4
88-27/9 M10x60 ISK	400	9	56	M10	27	4