

Product Group KVG/RE

Two-way push-in connector made of PA 6 for rectangular tube

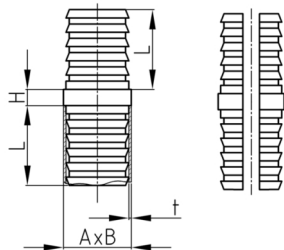

Standard Colours

- black

Material

- Base body: Polyamide (PA 6)

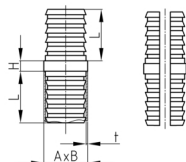

Product information

- With pin fit, for low to medium static load.
- 2-parts without core
- Two-piece variants are supplied unassembled.
- Order-related production for individual article sizes! Please ask for minimum quantity.

Order Number	A	B	H	L	t
	mm	mm	mm	mm	mm
KVG 30x15	30	15	5	38	1,5
KVG 30x20x1,5	30	20	5	37	1,5
KVG 40x20	40	20	5	36	1,5
KVG 50x20	50	20	5	40	2
KVG 50x30	50	30	5	49	2
KVG 60x40x2	60	40	5	48	2