

Product Group VJAF/RE

Adjusting plugs made of PA 6 for rectangular tubes with one piece outer body, injection moulded thread and felt slide base

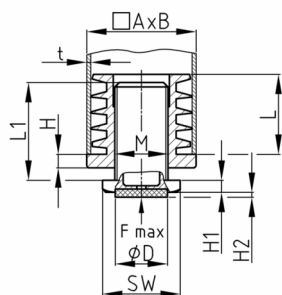

Standard Colours

- black RAL 9005

Material

- Base body: Polyamide (PA 6)
- Slide base: synthetic needle felt (polyester)

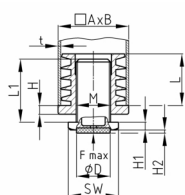

- The feet must be adjusted in an unloaded state.
- The specified axial, static load capacity refers to a screw turned out 10 mm and resting on the full surface.
- Adjusting plugs are not suitable as load gliders.
- Adjusting plugs are not suitable for dynamic load.

• *) K = split assembled outer part

• Please observe the material hints for polyamide (PA).

Product options on inquiry

- Further sizes
- Other special productions

Order Number	A	B	D	F max.	H	H1	H2	L	L1	M	WAF	t
	mm	mm	mm	kg	mm	mm	mm	mm	mm	mm	mm	mm
VJAF 50x30x1,5-2 M22x25/8k *	50	30	25	250	5	5	3	34	29	22	28	1,5-2
VJAF 60x40x1,5-2/M22x25/8k	60	40	25	400	5	5	3	29	29	22	28	1,5-2
VJAF 60x40x1,5-2/M22x60/8k	60	40	25	400	5	5	3	29	60	22	28	1,5-2