

### Product Group 71F

Adjusting screws with knurled plastic base made of PE, welded felt and overmoulded threaded bolt

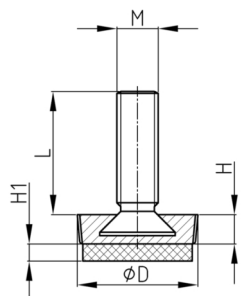

#### Standard Colours

- black

#### Material

- Thread: zinc-plated steel
- Base: Polyethylene (PE)
- Slide base: felt

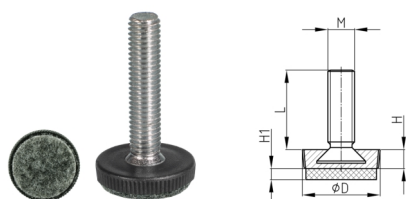

#### Product information

- Adjustable screws with foot-diameter 15 mm have no knurling.

#### Product options on inquiry

- Further thread lengths/sizes
- Stainless steel screws
- Plastic base in special colours according to RAL-System

Order Number	D	H	H1	L	M
	mm	mm	mm	mm	
71F-15 M5x16	15	5	3	13	M5
71F-15 M5x20	15	5	3	17	M5
71F-15 M5x25	15	5	3	22	M5
71F-15 M5x30	15	5	3	27	M5
71F-15 M5x40	15	5	3	37	M5
71F-15 M5x50	15	5	3	47	M5
71F-15 M6x12	15	6	3	9	M6
71F-15 M6x16	15	6	3	13	M6
71F-15 M6x20	15	6	3	17	M6
71F-15 M6x25	15	6	3	22	M6
71F-15 M6x30	15	6	3	27	M6
71F-15 M6x40	15	6	3	37	M6
71F-15 M6x50	15	6	3	47	M6
71F-20 M5x12	20	5	3	9	M5
71F-20 M5x16	20	5	3	13	M5
71F-20 M5x20	20	5	3	17	M5
71F-20 M5x25	20	5	3	22	M5
71F-20 M5x30	20	5	3	27	M5
71F-20 M5x40	20	5	3	37	M5
71F-20 M5x50	20	5	3	47	M5
71F-20 M6x12	20	6	3	9	M6



# Walter Bethke GmbH & Co. KG

Technische Kunststoff - und Hybridprodukte

Order Number	D	H	H1	L	M
	mm	mm	mm	mm	
71F-20 M6x14	20	6	3	11	M6
71F-20 M6x16	20	6	3	13	M6
71F-20 M6x20	20	6	3	17	M6
71F-20 M6x25	20	6	3	22	M6
71F-20 M6x30	20	6	3	27	M6
71F-20 M6x40	20	6	3	37	M6
71F-20 M6x50	20	6	3	47	M6
71F-20 M8x16	20	8	3	12	M8
71F-20 M8x20	20	8	3	16	M8
71F-20 M8x25	20	8	3	21	M8
71F-20 M8x30	20	8	3	26	M8
71F-20 M8x40	20	8	3	36	M8
71F-20 M8x50	20	8	3	46	M8
71F-20 M8x60	20	8	3	56	M8
71F-25 M5x16	25	5	3	13	M5
71F-25 M5x20	25	5	3	17	M5
71F-25 M5x25	25	5	3	22	M5
71F-25 M5x30	25	5	3	27	M5
71F-25 M5x40	25	5	3	37	M5
71F-25 M5x50	25	5	3	47	M5
71F-25 M6x12	25	6	3	9	M6
71F-25 M6x14	25	6	3	11	M6
71F-25 M6x16	25	6	3	13	M6
71F-25 M6x20	25	6	3	17	M6
71F-25 M6x25	25	6	3	22	M6
71F-25 M6x30	25	6	3	27	M6
71F-25 M6x40	25	6	3	37	M6
71F-25 M6x50	25	6	3	47	M6
71F-25 M8x16	25	8	3	12	M8
71F-25 M8x20	25	8	3	16	M8
71F-25 M8x25	25	8	3	21	M8
71F-25 M8x30	25	8	3	26	M8
71F-25 M8x40	25	8	3	36	M8
71F-25 M8x50	25	8	3	46	M8