

Product Group GLM

Metal-covered furniture glides made of PE

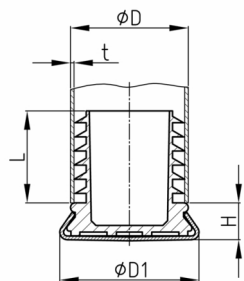

Standard Colours

- black RAL 9005

Material

- Base body: Polyethylene (PE)
- Slide base: stainless steel
- Slide base: nickel-plated steel

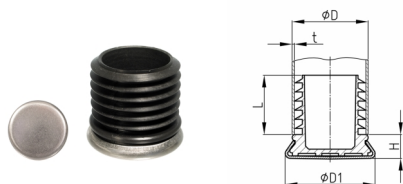

- K.vn= nickel-plated
- K.rf = stainless
- Attention, discontinued articles! The product group is taken out of our standard program.
- Similar products see GGM 2000 or DGGM.

Product options on inquiry

- Special colours (colours, minimum quantities, set-up costs, pricing and surcharges)

Order Number	D	D1	H	L ca.	t
	mm	mm	mm	mm	mm
GLM 19x1,5-2,5 K.rf	19	22	8	19	1,5-2,5
GLM 20x1,5-2,5 K.rf	20	22	8	19	1,5-2,5
GLM 22x1,5-2,5 K.vn	22	25	8	19	1,5-2,5
GLM 25x1-2,5 K.vn	25	30	8	19	1-2,5
GLM 28x1-2,5 K.rf	28	30	8	19	1-2,5
GLM 28x1-2,5 K.vn	28	30	8	19	1-2,5
GLM 30x1-2,5 K.vn	30	35	8	19	1-2,5