

### Product Group UGS/RU

Round universal glides with PTFE gliding surface for fastening with a screw

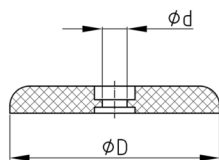

#### Standard Colours

- grey

#### Material

- Base body: rubber / EVAC
- Slide base: Polytetrafluorethylene (PTFE)

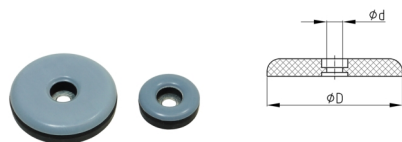

#### Product information

- Very good noise damping through rubber- / EVAC-buffers in the gliding insert.
- Good slippage due to PTFE gliding base surface
- Well suited for textile/carpet floors
- The floor glider is conditionally suitable for smooth floors (unintentional slipping of the chair - to be tested by the user).
- The abrasion of the sliding surface depends on the condition of the floor (surface, soiling of the floor, etc.) and the load on the chair (must be tested by the user, the manufacturer cannot provide any guarantee).
- Supplied with screw

Order Number	D	d ca.
	mm	
UGS 19 PTFE	19	4,3
UGS 22 PTFE	22	4,3
UGS 25 PTFE	25	4,3
UGS 30 PTFE	30	4,3
UGS 38 PTFE	38	4,3
UGS 50 PTFE	50	4,3
UGS 60 PTFE	60	4,3