

### Product Group GL

Lamella plugs made of polyethylene for round tubes

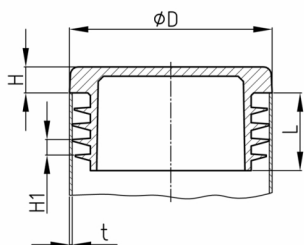

#### Standard Colours

- black RAL 9005
- signal white RAL 9003
- traffic grey A RAL 7042

#### Material

- Polyethylene (PE)

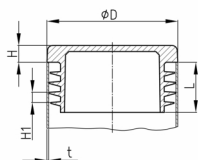

#### Product information

- Lamellar plugs without specification of the pipe wall thickness are generally suitable for pipe wall thicknesses 1.5 - 2 mm. Please indicate the pipe wall thickness when ordering.
- The plugs are intended for use in pipes or equivalent bores with free passage corresponding to the clear nominal width of at least shaft length.
- For technical production reasons, a residual sprue may exceed the shaft length.
- Material and design of shafts guaranteed stop against drop out and easy assembling.
- For use as a glides (conditional shear strength) and to attain an easy assembling in tubes with larger wall thickness, it is recommended to chamfer the inside diameter of the pipe (approx. 0.3 - 0.5 x 60°).
- Depending on the selected article, the surface finish can vary between polished and eroded.
- The ribs are circularly closed or interrupted.
- The ribs are not suitable for sealing against fluids.
- The number of slats per plug varies between 2-4 slats.
- „+“ = differing standard colours possible
- Your searched size / design is not included? - Please ask our sales team!
- As a rule, odd outside pipe diameters rounded to 1/10 mm (as part of the article or order number) indicate that these sizes originate from or are common in the Imperial system.

#### Product options on inquiry

- Special colours (colours, minimum quantities, set-up costs, pricing and surcharges)
- With your engraved company logo (tooling costs, minimum quantities, set-up costs)
- With your tampon printed company logo (set-up costs, minimum quantities, printing costs)
- Most plugs can also be made of suitable harder TPE's (TPE= thermoplastic elastomer --> extended range of operating temperature, noise absorbing, non-skid).

Order Number	D	H	H1	L	t
	mm	mm	mm	mm	mm
GL 10x0,8-1,5	10	3,5	2	10	0,8-1,5
GL 12x0,8-2	12	3,5	2,5	10	0,8-2
GL 13x0,8-2	13	4	3	10,5	0,8-2
GL 14x0,8-2	14	5	3	11,5	0,8-2
GL 15x0,8-2	15	3	3	11,5	0,8-2
GL 16x0,8-2	16	5	3	11,5	0,8-2
GL 18x0,25-1,5	18	5	3	11,5	0,25-1,5
GL 18x0,8-2,5	18	5	3	11,5	0,8-2,5



# Walter Bethke GmbH & Co. KG

Technische Kunststoff - und Hybridprodukte

Order Number	D	H	H1	L	t
	mm	mm	mm	mm	mm
GL 18x2,5-3,5	18	5	3	11,5	2,5-3,5
GL 19x0,8-2,5	19	5	3	11,5	0,8-2,5
GL 20x0,8-2,5	20	5	3	11,5	0,8-2,5
GL 21x0,8-2,5	21	5	3	11,5	0,8-2,5
GL 22x0,8-3	22	5	3	11,5	0,8-3
GL 22x2-4	22	5	3	11,5	2-4
GL 23x0,8-3	23	5	3	11,5	0,8-3
GL 24x0,8-2,5	24	5	3	11,5	0,8-2,5
GL 25x1-3	25	5	3	11,5	1-3
GL 25x3-5	25	5	3	11,5	3-5
GL 26x0,8-3	26	5	3	11,5	0,8-3
GL 27x0,8-3	27	5	3	11,5	0,8-3
GL 28x0,8-2,5	28	5	3	11,5	0,8-2,5
GL 30x0,8-2,5	30	5	3	11,5	0,8-2,5
GL 30x2,5-4,5	30	5	3	11,5	2,5-4,5
GL 32x0,8-3	32	5	3	11,5	0,8-3
GL 32x2,5-4,5	32	5	3	11,5	2,5-4,5
GL 34x0,8-3	34	5	3	11,5	0,8-3
GL 34x3,5-4	34	5	3	11,5	3,5-4
GL 35x1-3	35	5	3	11,5	1-3
GL 35x3-5	35	5	3	11,5	3-5
GL 36x1-3	36	5	3	11,5	1-3
GL 37x1-3	37	5	3	11,5	1-3
GL 38x1-3	38	5	3	11,5	1-3
GL 38x3-5	38	5	3	11,5	3-5
GL 40x1-3	40	5	3	11,5	1-3
GL 40x3-5	40	5	3	11,5	3-5
GL 42x0,8-2,5	42	5	3	11,5	0,8-2,5
GL 42x2,5-5	42	5	3	11,5	2,5-5
GL 43x2-2,5	43	5	3	11,5	2-2,5
GL 43x3-3,5	43	5	3	11,5	3-3,5
GL 44,5x1,2-3,2	44,5	5	3	11,5	1,2-3,2
GL 45x0,8-3	45	5	3	11,5	0,8-3
GL 45x3-5	45	5	3	11,5	3-5
GL 46x1,5-3,5	46	5	3	11,5	1,5-3,5
GL 48,4x1,2-3,6	48,3	6	3	11,5	1,2-3,6
GL 48,4x2,5-5,2	48,3	6	3	11,5	2,5-5,2
GL 50x1-2,5	50	5	3	11,5	1-2,5
GL 50x2,5-4,5	50	5	3	11,5	2,5-4,5
GL 50x4,5-6,5	50	5	3	11,5	4,5-6,5
GL 50,8x1,2-3	50,8	5	3	11,5	1,2-3
GL 52x1,5-3,5	52	5	3	14,5	1,5-3,5
GL 55x1-3	55	5	3	14,5	1-3
GL 55x3-5	55	5	3	14,5	3-5
GL 57,2x1,2-2,7	57,2	5	3	14,5	1,2-2,7
GL 60x1-3	60	5	4	18	1-3
GL 60x3-5	60	5	4	18	3-5



# Walter Bethke GmbH & Co. KG

Technische Kunststoff - und Hybridprodukte

Order Number	D	H	H1	L	t
	mm	mm	mm	mm	mm
GL 63,5x1,5-3,5	63,5	5	4,5	21	1,5-3,5
GL 65x1,5-3,5	65	5	4,5	21	1,5-3,5
GL 65x3-5	65	5	4,5	21	3-5
GL 70x1-3,5	70	5	4,5	21	1-3,5
+ GL 70x2-4,5	70	5	4	21	2-4,5
GL 75x1-3,5	75	6	4,5	21	1-3,5
GL 75x3-5	75	6	5	21	3-5
GL 76,2x1,5-3,5	76,2	6	4,5	21	1,5-3,5
GL 76,2x3,5-6	76,2	6	4,5	21	3,5-6
+ GL 80x1,5-3	80	4	5	21	1,5-3
GL 80x3-5,5	80	6	5	21	3-5,5
GL 82,6x2-4,5	82,6	6	5	21	2-4,5
GL 85x1,5-4	85	6	5	21	1,5-4
GL 85x3,5-6	85	6	4,5	21	3,5-6
GL 88,9x1,8-4	88,9	6	4,5	21	1,8-4
GL 88,9x3,5-6	88,9	6	4,5	21	3,5-6
GL 90x1,5-4	90	6	4,5	21	1,5-4
+ GL 90x2,5-5	90	5		20	2,5-5
GL 95x1,5-4	95	6	4,5	21	1,5-4
GL 100x1,5-4	100	6	5	28	1,5-4
GL 100x4-6,5	100	6	5	28	4-6,5
GL 100x6,5-9	100	6	5	28	6,5-9
GL 101,6x3,6-5	101,6	6	5	28	3,6-5
+ GL 102x2-4	102	5	6	20	2-4
GL 105x2-4,5	105	6	5	28	2-4,5
GL 108x2,5-4,5	108	6	5	28	2,5-4,5
GL 110x2-4,5	110	6	5	28	2-4,5
GL 114,3x3,2-5,5	114,3	6	5	28	3,2-5,5
GL 120x2-4	120	6	5	28	2-4
GL 125x1-4	125	6	6	34	1-4
GL 125x4-7,5	125	6	6	34	4-7,5
GL 127x2-5	127	6	6	34	2-5
GL 127x5-8,5	127	6	6	34	5-8,5
GL 130x2-6	130	6	6	34	2-6
GL 133x2-6	133	6	6	34	2-6
GL 140x2-6,5	140	6	6	34	2-6,5
GL 150x2-6	150	6	6	34	2-6
GL 152,4x3,2-7,5	152,4	6	6	34	3,2-7,5
GL 159x2-6,5	159	6	6	34	2-6,5
GL 160x2,5-7	160	6	6	34	2,5-7
GL 165,1x3,2-7,5	165,1	6	6	34	3,2-7,5
GL 168,3x2-6,5	168,3	6	6	34	2-6,5
GL 177,8x3,2-8	177,8	6	6	34	3,2-8
GL 193,7x2,9-7	193,7	6	6	34	2,9-7
+ GL 219,1 (220) x 3,2-6,5	219,1 (220)	6	6	34	3,2-6,5
+ GL 260 x 4,5-8	260	6	6	34	4,5-8
+ GL 240 x 4,5-8	240	6	6	34	4,5-8



# Walter Bethke GmbH & Co. KG

Technische Kunststoff - und Hybridprodukte

Order Number	D	H	H1	L	t
	mm	mm	mm	mm	mm
+ GL 273 x 2,9-6	273	6	6	39	2,9-6