

Product Group R 33-1

Swivel castors with bolt hole, wheel/axle riveted, plain bearing

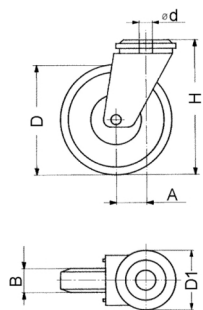

Standard Colours

- grey / core black

Material

- Rim: Polyamide (PA)
- Housing: zinc-plated steel
- Tyre: elastic thermoplast

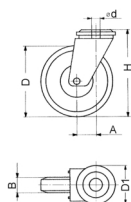

Order Number	A	B	d	D	D1	H	Weight	Load capacity
	mm	mm	mm	mm	mm	mm	kg	kg
R3301	19	18	10	50	35	64	0,1	40
R3303	37	24	10	75	48	98	0,3	55
R3305	38	24	10	100	48	120	0,37	55