

### Product Group LBS1

Round covering plugs made of POM for different thicknesses of wall and diameters

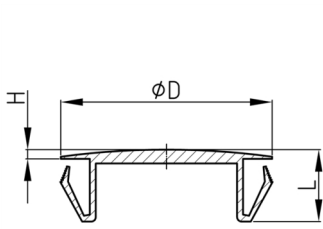

#### Standard Colours

- black

#### Material

- Polyoxymethylene (POM, also Polyacetal)

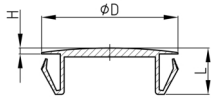

Blech, Platte / Sheet, Panel

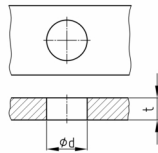

#### Product information

- For closure of unused bores or assembly holes in sheets, panels and housings
- Sizes for holes between 9,5 and 47,5 mm
- Simple, fast and sure
- Free of halogen
- Permissible operating temperature  $-40^{\circ}\text{C}$  to  $+90^{\circ}\text{C}$
- Only one component for different hole diameter

Order Number	d mm	D mm	H mm	L mm	t mm
LBS1 391689	9,5-11,0	16	1,6	12,6	0,8-3,2
LBS1 391697	12,7-14,3	18,5	1,6	12	0,8-3,2
LBS1 313564	15,0-17,5	21,5	1,6	12	0,8-3,2
LBS1 391670	18,4-20,6	25	1,6	12	0,8-3,2
LBS1 304417	22,0-25,5	32,5	1,6	13,2	0,8-3,2
LBS1 391700	28,0-30,0	35	1,6	13,2	0,8-3,2
LBS1 391573	35,0-38,0	43	1,6	13,2	0,8-3,2
LBS1 391581	45,0-47,5	52	1,6	13,2	0,8-3,2