

### Product Group CTM

Sight plugs made of PE with chrome-/nickel-coloured metal cover for round tubes

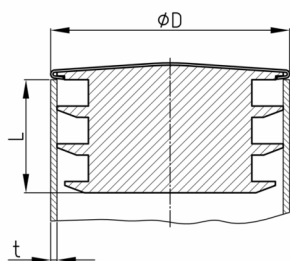

#### Standard Colours

- chrome-/ nickel coloured

#### Material

- Polyethylene (PE)

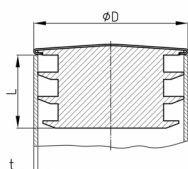

#### Product information

- Chrome-/nickel-coloured metal cover:
- The metal cover features normally has some play to the plug.
- The metal cover is conditionally scratch-resistant and is not considered to be high-gloss nickel-plated.
- The metal cover has limited corrosion resistance (outdoor application + humidity).
- As a rule, odd outside pipe diameters rounded to 1/10 mm (as part of the article or order number) indicate that these sizes originate from or are common in the Imperial system.
- \* )= The plug can also be used from a wall thickness of 1 mm. We recommend checking this before installation.
- \*\* ) = The plug can also be used up to a wall thickness of 2 mm. We recommend checking this before installation.

Order Number	D	L	t
	mm	mm	mm
CTM 13	13	8	1-1,5
CTM 14	14	10	1-1,5
CTM 16	16	10	1-1,5
CTM 18	18	10	1,5-2
CTM 19 *	19	10	1,5-2
CTM 20 **	20	10	1-1,5
CTM 22 **	22	11	1-1,5
CTM 25x1(1,5)	25	15	1(1,5)
CTM 25x1,5	25	15	1,5(2)
CTM 25x2	25	15	2
CTM 28 *	28	15	1,5-2
CTM 30 **	30	16	1-1,5
CTM 32 **	32	16	1-1,5
CTM 35 **	35	16	1-1,5
CTM 38	38	16	1,5-2
CTM 40 *	40	16	1,5-2
CTM 45	45	16	1-1,5