

### Product Group MFCF

Eccentric machine feet made of stainless steel with one fixing hole, optional with ant slip pad

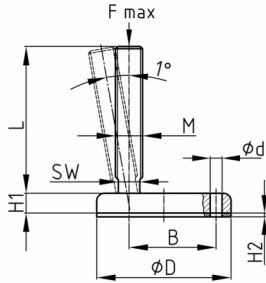

#### Material

- Base body: AISI 304 (A2)
- Rubber: NBR 72 Shore

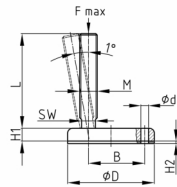

#### Product information

- The machine foot has its threaded spindle displaced from the centre of the foot plate which provides a larger distance between spindle and fixing hole.
- The solid stainless steel design makes the foot highly resilient. The rounded shape makes cleaning easier.
- The load capacity of the screw (buckling length!) may be less than indicated in the table.
- The base is optionally available with a non-slip rubber plate that is firmly bonded to the stainless steel plate.
- Please order separately (MFCFxG, x = D)!

Order Number	D	B	H1	H2	d	F max.	M	L	WAF
	mm	mm	mm	mm	mm	kg		mm	mm
MFCF 110 / M16x100	110	70	14	5	13	6000	M16	100	13
MFCF 110 / M16x150	110	70	14	5	13	6000	M16	150	13
MFCF 110 / M16x180	110	70	14	5	13	6000	M16	180	13
MFCF 110 / M16x230	110	70	14	5	13	6000	M16	230	13
MFCF 110 / M20x100	110	70	14	5	13	6000	M20	100	17
MFCF 110 / M20x150	110	70	14	5	13	6000	M20	150	17
MFCF 110 / M20x180	110	70	14	5	13	6000	M20	180	17
MFCF 110 / M20x230	110	70	14	5	13	6000	M20	230	17
MFCF 110 / M24x100	110	70	14	5	13	6000	M24	100	19
MFCF 110 / M24x150	110	70	14	5	13	6000	M24	150	19
MFCF 110 / M24x180	110	70	14	5	13	6000	M24	180	19
MFCF 110 / M24x230	110	70	14	5	13	6000	M24	230	19
MFCF 110G	110								

#### Ordering example

- Group + D + M + Thread Length ---> MFCF 110 M16 x 100