

### Product Group KBKPROZ5B

3-ways-manifold made of PP with 3x120° junction boxes for cable chain KBKPRO and KBKCMX

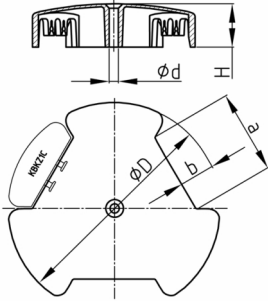

#### Standard Colours

- black
- silver
- white

#### Material

- Polypropylene (PP)



#### Product information

- The patented distributor makes the cable chain a network-capable cable routing system.
- The manifold is clamped onto the cable chain without tools via coupling links.
- Manifold can be used fixed by a central fixing hole and as cable outlet.
- Not needed connecting sockets can be closed by covering cap "KBKZ1C" (please order separately).
- The manifold will be delivered with 3 coupling elements "KBKCUBE" and 3 connectors "KBKZ25" .
- Delivery incl. 3 joining elements KBKCUBE, 3 connectors KBKZ25
- Tread-proof for short periods up to approx. 100 kg

Order Number	a	b	d	D	H
	mm	mm	mm	mm	mm
KBKPROZ5B / Switch	55	25	6,5	148	30