

### Product Group EBQM2

Assembled expander plugs with collar made of PA for square tubes with two hexagon nuts

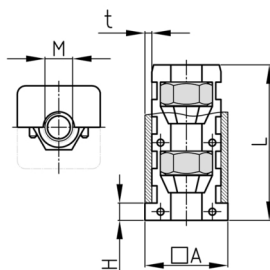

#### Standard Colours

- black

#### Material

- Base body: Polyamide (PA)
- Nut: zinc-plated steel

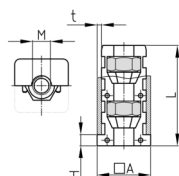

#### Product information

- These two-piece expander bushes with collar have conical chambers for hexagon nuts and screws. Tightening of the thread presses the outer wall of the insert against the inner tube wall (rawle plug effect). This effect requires entire tightening of the thread.
- The bushings are designed for precisely defined wall thicknesses according to the specifications in the table.
- The load capacity data refer to the use in steel tubes.
- Order-related production for individual article sizes! Please ask for minimum quantity.
- OL = without ribs
- LG = special type with 3 nut cavities
- Use as threaded plugs in combination with adjustable feet or adjusting screws -> see category "Adjustment and levelling parts" - Expander effect only with fully tightened adjusting screw!
- Tube extensions (1 expander with nut and 1 expander with screw)
- Fixing of wheels and castors

Order Number	A	H	L	M	t	F max.
	mm	mm	mm		mm	kg
EBQM2 20x20x1,5 /M 6	20	5	42	M6	1,5	150
EBQM2 20x20x1,5 /M8	20	5	42	M8	1,5	300
EBQM2 20x20x1,5 /M8 OL	20	5	42	M8	1,5	300
EBQM2 22x22x1,5 /M8	22	5	40	M8	1,5	300
EBQM2 25x25x1,5 /M8	25	5	41	M8	1,5	300
EBQM2 25x25x1,5 /M10	25	5	42	M10	1,5	300
EBQM2 30x30x1,5 /M8	30	5	42	M8	1,5	300
EBQM2 30x30x1,5 /M10	30	5	42	M10	1,5	300
EBQM2 30x30x2 /M8	30	5	42	M8	2	300
EBQM2 30x30x2 /M10	30	5	42	M10	2	300
EBQM2 31,75x31,75x1,2-1,6/M10	31,75	5	37	M10	1,2-1,6	300
EBQM2 32x32x2 /M10	32	5	37	M10	2	300
EBQM2 35x35x1,6 /M10	35	5	37	M10	1,6	300
EBQM2 35x35x2 /M10	35	5	42	M10	2	300
EBQM2 38x38x1,5 /M10	38	5	36	M10	1,5	300



# Walter Bethke GmbH & Co. KG

Technische Kunststoff - und Hybridprodukte

Order Number	A	H	L	M	t	F max.
	mm	mm	mm		mm	kg
EBQM2 38x38x1,5 /M12	38	5	36	M12	1,5	300
EBQM2 40x40x1,5 /M10	40	5	42	M10	1,5	300
EBQM2 40x40x2 /M10	40	5	42	M10	2	300
EBQM2 40x40x2 /M10 LG	40	5	88	M10	2	300
EBQM2 40x40x2 /M12	40	5	40	M12	2	300
EBQM2 40x40x3 /M10	40	5	37	M10	3	300
EBQM2 50x50x1,5 /M10	50	5	37	M12	1,5	300
EBQM2 50x50x1,5 /M12	50	5	37	M14	1,5	300
EBQM2 50x50x2 /M12	50	5	37	M12	2	300
EBQM2 50x50x2,5-3 /M12	50	5	39	M12	2	300
EBQM2 50,8x50,8x1,6 /M10	50,8	5	38	M10	1,6	300
EBQM2 60x60x2 /M10	60	5	38	M10	2	300
EBQM2 60x60x2 /M10 LG	60	5	86	M10	2	300
EBQM2 60x60x2,5 /M10	60	5	41	M10	2,5	300
EBQM2 70x70x2 /M10	70	5	42	M10	2	300