

Product Group 74

Adjusting screws with round plastic base made of PA and hexagon above the base, thread bolt overmoulded

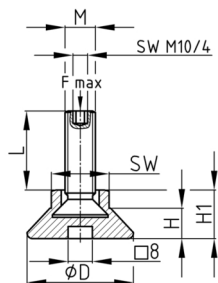

Standard Colours

- black

Material

- Thread: zinc-plated steel
- Base: Polyamide (PA)

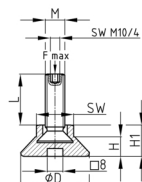

- The axial, static foot load applies to a perfectly level standing surface.
- 8 mm square in base underside

Product options on inquiry

- Further thread lengths/sizes
- Stainless steel screws
- Hexagon socket in the thread end has the dimensions M8/WAF 4, M10/ WAF 5
- Plastic base in special colours according to RAL-System

Order Number	D	F max.	H	H1	L	M	WAF
	mm	kg	mm	mm	mm		mm
74-35 / M8x25	35	400	11	16,5	16	M8	17
74-35 / M8x30	35	400	11	16,5	21	M8	17
74-35 / M8x40	35	400	11	16,5	31	M8	17
74-35 / M8x50	35	400	11	16,5	41	M8	17
74-35 / M10x25	35	500	11	16,5	16	M10	17
74-35 / M10x30	35	500	11	16,5	21	M10	17
74-35 / M10x40	35	500	11	16,5	31	M10	17
74-35 / M10x50	35	500	11	16,5	41	M10	17
74-35 / M10x60	35	500	11	16,5	51	M10	17