

### Product Group 79

Adjusting screws with octagonal plastic base and hexagon above the base made of PA, thread bolt overmoulded

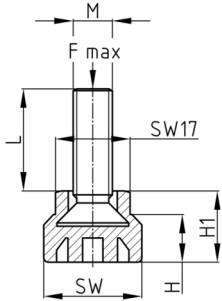

#### Standard Colours

- black

#### Material

- Thread: zinc-plated steel
- Base: Polyamide (PA)

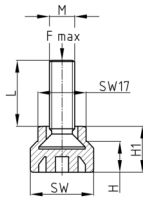

- The axial, static foot load applies to a perfectly level standing surface.

#### Product options on inquiry

- Further thread lengths/sizes
- Stainless steel screws
- Plastic base in special colours according to RAL-System
- Hexagon socket in thread end

Order Number	F max. kg	H mm	H1 mm	L mm	M	WAF mm
79-25 / M8x20	300	13	18	12	M8	25
79-25 / M8x25	300	13	18	17	M8	25
79-25 / M8x30	300	13	18	22	M8	25
79-25 / M8x40	300	13	18	32	M8	25
79-25 / M8x50	300	13	18	42	M8	25