

Product Group 88

Adjustable screws with octagonal plastic base made of PA, thread bolt overmoulded

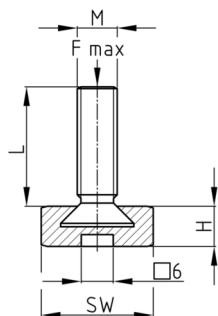

Standard Colours

- black

Material

- Thread: zinc-plated steel
- Base: Polyamide (PA)

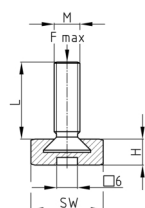

- The axial, static foot load applies to a perfectly level standing surface.
- 6 mm square in base underside

Product options on inquiry

- Further thread lengths/sizes
- Stainless steel screws
- Plastic base in special colours according to RAL-System

Order Number	F max. kg	H mm	L mm	M	WAF mm
88-27/8 / M8x16	400	8	12	M8	27
88-27/8 / M8x20	400	8	16	M8	27
88-27/8 / M8x25	400	8	21	M8	27
88-27/8 / M8x30	400	8	26	M8	27
88-27/8 / M8x40	400	8	36	M8	27
88-27/8 / M8x50	400	8	46	M8	27
88-27/9 / M10x25	400	9	21	M10	27
88-27/9 / M10x30	400	9	26	M10	27
88-27/9 / M10x40	400	9	36	M10	27
88-27/9 / M10x50	400	9	46	M10	27
88-27/9 / M10x60	400	9	56	M10	27