

### Product Group MFEA

Articulated machine feet made of glass fibre-reinforced polyamide, galvanised steel thread and vibration-damping rubber base

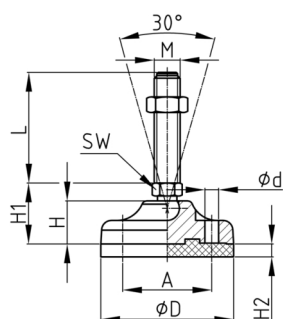

#### Standard Colours

- black

#### Material

- Thread: zinc-plated steel
- Base: glass fibre reinforced polyamide (PA-GF)
- Rubber: NBR 70 Shore

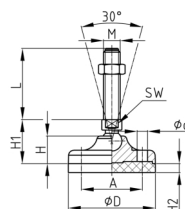
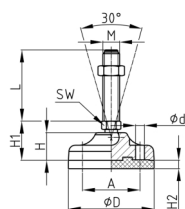

#### Product information

- A thicker rubber plate absorbs oscillations and vibrations.
- The machine foot can compensate for uneven floors up to 30°.
- There are two prepared screw-on holes (closed).
- The load capacity of the screw (buckling length!) may be less than indicated in the table.
- Compressors, feeders, vibrators, cleaning machines
- The foot is used in work areas with low stress.
- The vulcanised polyamide base is used to solve vibration problems.

The base is made of vulcanised polyamide and is used to solve vibration problems.

#### Product options on inquiry

- Delivery with additional steel nut possible.

A	D	d	F max.	H	H1	H2	M	WAF	50	75	100	125	150	175	200	225	250
mm	mm	mm	kg	mm	mm	mm		mm	mm	mm	mm	mm	mm	mm	mm	mm	mm
55	83	8,5	2000	27	38	10	M16	16	x	x	x	x	x	x	x		
55	83	8,5	2000	27	41	10	M20	17		x	x	x	x	x	x	x	
73	103	12,5	2500	32	51	10	M16	20	x	x	x	x	x	x	x	x	
73	103	12,5	2500	32	51	10	M20	20		x	x	x	x	x	x	x	x
73	103	12,5	2500	32	51	10	M24	20		x	x	x	x	x	x	x	x
87	123	12,5	3500	37	57	10	M16	20	x	x	x	x	x	x	x	x	
87	123	12,5	3500	37	57	10	M20	20		x	x	x	x	x	x	x	x
87	123	12,5	3500	37	57	10	M24	20		x	x	x	x	x	x	x	x
87	123	12,5	3500	37	58	10	M30	26			x	x	x	x	x	x	x

#### Ordering example

- Group + D + M + Thread Length ---> MFEA 83 M16x 50