

### Product Group MFPP

Machine feet made of glass fibre reinforced polyamide with zinced steel thread and antislip pad (A)

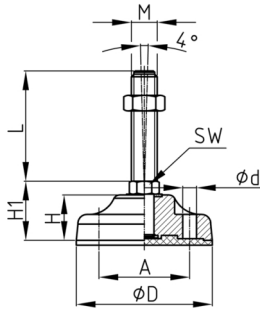

#### Standard Colours

- black

#### Material

- Thread: zinc-plated steel
- Base: glass fibre reinforced polyamide (PA-GF)
- Antislip pad: NBR 70 Shore

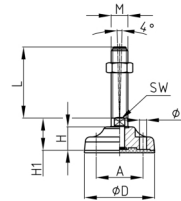
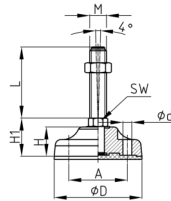

#### Product information

- Depending on the size of the thread or the foot diameter, the machine foot is provided with a chamfer on both sides or with a hexagon as a spanner flat.
- The machine foot can compensate for uneven floors up to 4°.
- There are two prepared screw-on holes (closed).
- The load capacity of the screw (buckling length!) may be less than indicated in the table.
- L = lower maximum load
- Packaging industry, conveyor systems, automation industry, office desks, aluminium profiles

A	D	d	F max.	H	H1	M	WAF	50	75	100	125	150	175	200	225	250
mm	mm	mm	kg	mm	mm		mm	mm	mm	mm	mm	mm	mm	mm	mm	mm
56	83	8,5	1000	28	36	M10	16	x	x	x	x					
56	83	8,5	1500	28	36	M12	16	x	x	x	x					
56	83	8,5	2500	28	36	M14	16	x	x	x	x	x	x			
56	83	8,5	2500	28	36	M16	16	x	x	x	x	x	x	x		
56	83	8,5	2500	28	40	M20	17		x	x	x	x	x	x	x	
73	103	12,5	3500	33	45	M16	17	x	x	x	x	x	x	x	x	
73	103	12,5	3500	33	45	M20	17		x	x	x	x	x	x	x	
73	103	12,5	3500	33	47	M24	20		x	x	x	x	x	x	x	
87	123	12,5	4500	37	50	M16	20	x	x	x	x	x	x	x	x	
87	123	12,5	4500	37	50	M20	20		x	x	x	x	x	x	x	
87	123	12,5	4500	37	50	M24	20		x	x	x	x	x	x	x	x
87	123	12,5	4500	37	50	M30	26			x	x	x	x	x	x	x
87	123	12,5	4000	37	50	M16	17			x				x		
87	123	12,5	4000	37	50	M20	17			x				x		

#### Ordering example

- Group + D + M + Thread Length ----> MFPP 83 M10x 50 (A)