

### Product Group MFPFS

Machine feet made of glass fibre reinforced polyamide with stainless steel thread and antislip pad (A)

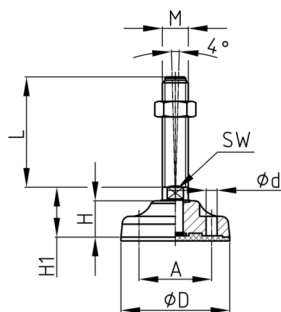

#### Standard Colours

- black

#### Material

- Thread: AISI 304 (A2)
- Base: glass fibre reinforced polyamide (PA-GF)
- Antislip pad: NBR 70 Shore

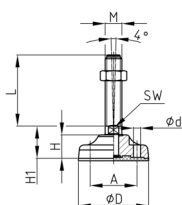

#### Product information

- The machine foot can compensate for uneven floors up to 4°.
- There are two prepared screw-on holes (closed).
- The load capacity of the screw (buckling length!) may be less than indicated in the table.
- L = lower maximum load
- Packaging industry, conveyor systems, automation industry, office desks, aluminium profiles

#### Product options on inquiry

- Thread made of stainless steel AISI 316 (A4)
- Delivery with additional steel nut possible.

A	D	d	F max.	H	H1	M	WAF	50	75	100	125	150	175	200	225	250
mm	mm	mm	kg	mm	mm		mm	mm	mm	mm	mm	mm	mm	mm	mm	mm
56	83	8,5	1500	28	36	M10	13	x	x	x	x					
56	83	8,5	1500	28	36	M12	13	x	x	x	x					
56	83	8,5	2000	28	36	M14	13	x	x	x	x	x	x			
56	83	8,5	2000	28	40	M16	13	x	x	x	x	x	x	x		
56	83	8,5	2000	28	40	M20	17		x	x	x	x	x	x	x	
73	103	12,5	3500	33	45	M16	17	x	x	x	x	x	x	x	x	
73	103	12,5	3500	33	45	M20	17		x	x	x	x	x	x	x	
73	103	12,5	3500	33	47	M24	20		x	x	x	x	x	x	x	
87	123	12,5	4500	37	50	M16	20	x	x	x	x	x	x	x	x	
87	123	12,5	4500	37	50	M20	20		x	x	x	x	x	x	x	
87	123	12,5	4500	37	50	M24	20		x	x	x	x	x	x	x	x
87	123	12,5	4500	37	50	M30	26			x	x	x	x	x	x	x
87	123	12,5	4000	37	50	M16	17			x				x		
87	123	12,5	4000	37	50	M20	17			x				x		

#### Ordering example

- Group + D + M + Thread Length ---> MFPFS 83 M10x 50 (A)