

Product Group MFSSE

Machine feet made of stainless steel with antislip pad

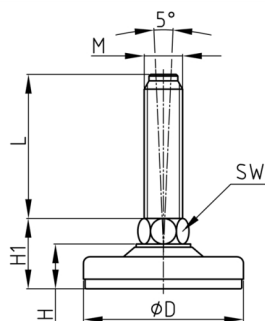

Material

- Base body: AISI 304 (A2)
- Antislip pad: NBR 70 Shore

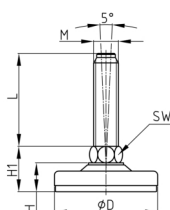

Product information

- The thread is screwed into the foot and can be turned!
- The machine foot can compensate for uneven floors up to 5°.
- The load capacity of the screw (buckling length!) may be less than indicated in the table.

Product options on inquiry

- Machine foot made of stainless steel AISI 316 (A4)
- Delivery with additional steel nut possible.

Order Number	D	F max.	H	H1	L	M	WAF
	mm	kg	mm	mm	mm		mm
MFSSE 50 / M10x25 A	50	1200	13	23	25	M10	14
MFSSE 50 / M10x50 A	50	1200	13	23	50	M10	14
MFSSE 50 / M10x75 A	50	1200	13	23	75	M10	14
MFSSE 50 / M10x100 A	50	1200	13	23	100	M10	14
MFSSE 50 / M12x25 A	50	1200	13	23	25	M12	14
MFSSE 50 / M12x50 A	50	1200	13	23	50	M12	14
MFSSE 50 / M12x75 A	50	1200	13	23	75	M12	14
MFSSE 50 / M12x100 A	50	1200	13	23	100	M12	14
MFSSE 50 / M12x125 A	50	1200	13	23	125	M12	14
MFSSE 50 / M14x50 A	50	1200	13	23	50	M14	14
MFSSE 50 / M14x75 A	50	1200	13	23	75	M14	14
MFSSE 50 / M14x100 A	50	1200	13	23	100	M14	14
MFSSE 50 / M14x125 A	50	1200	13	23	125	M14	14
MFSSE 50 / M14x150 A	50	1200	13	23	150	M14	14

Ordering example

- Group + D + M + Thread Length ----> MFSSE 50 M10x 25 A