

Product Group MFTG

Machine feet made of glass fibre reinforced polyamide with stainless steel thread and stainless steel sealing bush

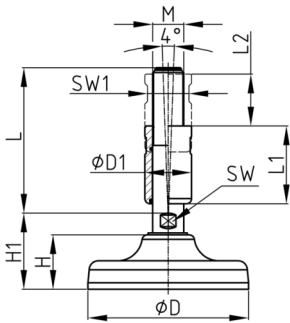

Standard Colours

- grey

Material

- Thread: AISI 304 (A2)
- Bush: AISI 304 (A2)
- Base: glass fibre reinforced polyamide (PA-GF)

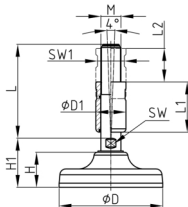

Product information

- The machine base has a sealing bush that covers parts of the thread. An O-ring is incorporated inside the bush. The sealing ring prevents the penetration of dirt by mechanically sticking to the thread surface. Thus the strictest legal hygiene standards are fulfilled.
- Die abgerundete Form und der verdeckte Übergang vom Fuß zum Gewinde erleichtern die Reinigung.
- The machine foot can compensate for uneven floors up to 4°.
- The load capacity of the screw (buckling length!) may be less than indicated in the table.
- Pharmaceutical industry, food industry, beverage industry, dairies, chemical industry

Product options on inquiry

- Machine foot made of stainless steel AISI 316 (A4)

Order Number	D	D1	F max.	H	H1	L	L1	L2	M	WAF	SW1
	mm	mm	kg	mm	mm	mm	mm	mm		mm	mm
MFTG 103 / M20x150	103	30	2000	37	52	150	60	40	M20	17	26
MFTG 103 / M24x150	103	35	2000	37	52	150	60	40	M24	20	30
MFTG 123 / M20x150	123	30	3000	42	57	150	60	40	M20	17	26
MFTG 123 / M24x150	123	35	3000	42	57	150	60	40	M24	20	30
MFTG 123 / M30x150	123	42	3000	42	57	150	60	40	M30	26	36