



# Walter Bethke GmbH & Co. KG

Technische Kunststoff - und Hybridprodukte

**Product Group** PCR

Adjusting screws with round plastic base made of PE, thread bolt overmoulded

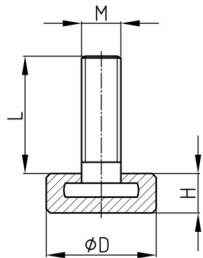

### Standard Colours

- black

### Material

- Thread: zinc-plated steel
- Base: Polyethylene (PE)

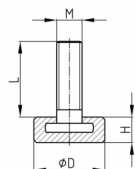

Order Number	D	H	L	M
	mm	mm	mm	
PCR 23 / M8x20	23	12	20	M8
PCR 23 / M10x20	23	12	20	M10